

BSB 500 Bandsaw Machine



Technical Specifications

Wheel Diameter:	500 mm
Saw Blade Length:	min. 4060 mm / max. 4140 mm
Saw Blade Width:	15 - 25 mm (6 - 25 mm with special crowned surface)
Saw Blade Thickness:	0.4 - 0.5 mm
Surface Width:	30 mm
Saw Blade Speed:	1300 m/min
Cutting Height:	max. 330 mm
Cutting Width:	max. 480 mm
Table Size:	500 x 680 mm
Table Dimensions:	900 mm
Bandsaw Blade Guide:	APA 2 (Size 1)
Laser Cut Position Indicator (Option):	Laser class 1M
Motor Power:	Standard: 1.5 kW (2.0 HP) Option: 2.2 kW (3.0 HP)
Motor Brake:	electrical (mechanical with optional 2.2 kW motor)
Protection Class:	IP54
Spare Requirement:	see next page
Net Weight:	approx. 220 kg
Voltage:	400 V / 50 Hz
Supply Cable:	Cu, 5-wire (Cross-section must be determined on site by a qualified electrician!)
Connecting Phases:	L1 L2 L3 N PE
Fuse Protection:	16 A
Extraction:	2 x Ø 100 mm Volume flow: 790 m ³ /h
Extraction Power:	approx. 1450 m ³ /h at 20 m/s (dry chips)
Signal Generator Lines for Extraction Unit:	Terminal 1 + 2 on rotary cam switch contact S2 (from 2.2 kW only!)



- Caution: The regulations of the local EVU apply.
- Checking the impedance of the fault loop and the suitability of the overcurrent protection devices must be carried out at the installation site of the machine.
- The electrical connection may only be carried out by an authorised electrician.
- The circuit diagram can be found in the machine column behind the control panel.

Emission Values according to EN ISO 746:2010

Noise Level ¹	Idle: 80 dB(A) Working: 102 dB(A)
Emission Pressure Level at the Workplace ¹	Idle: 67 dB(A) Working: 89 dB(A)
Workplace-related Dust Emission Value ^{2 3}	0.44 mg/m ³



As soon as the workplace-related noise emission values of the machine exceed 85 dB(A), suitable hearing protection must be made available to the personnel!

¹ Uncertainty allowance K = 4 dB(A) | ² Permissible: 2.0 mg/m³ air | ³ Dust emission values determined acc. to GS-HO-05

Dimensions and Working Areas

Front View:

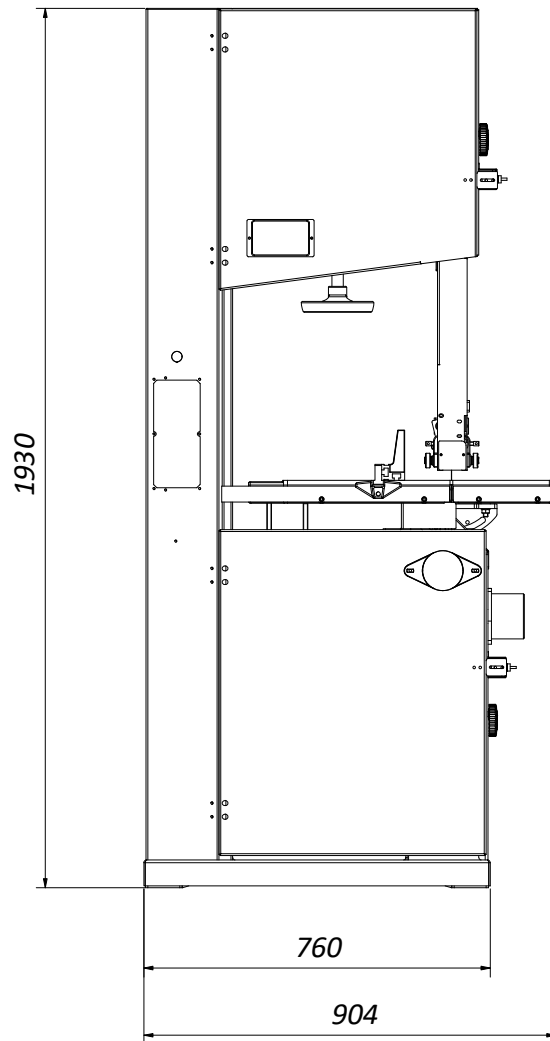

Side View:

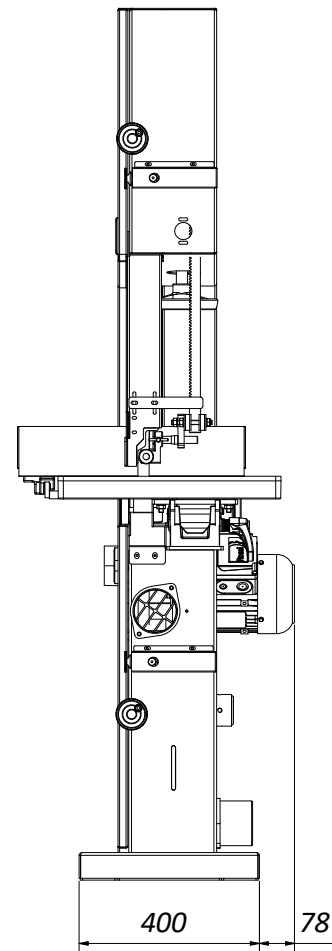

Top View:

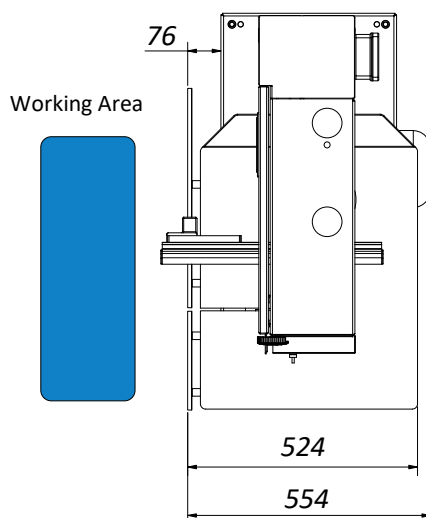

Space Requirement:

The effective space requirement usually depends on the dimensions of the machine and the dimensions of the workpieces to be machined.

In general, provide sufficient space around the machine and also calculate the required workplace for the operating personnel and for the infeed and outfeed of the workpieces.

HOKUBEMA Maschinenbau GmbH

Graf-Stauffenberg-Kaserne, Binger Str. 28 | Halle 120

DE 72488 Sigmaringen (Germany) | Tel. +49 07571 755-0

E-Mail: info@hokubema-panhans.de | Web: <https://hokubema-panhans.de>